

BENEFITS

- Wide rivets range.
- Rivets with Multi-grip range feature.
- The mandrel is completely locked to get resistance.
- Special designs.
- Packaged according to the customers' needs.
- Protective lacquered and coatings.

TYPES OF HEAD

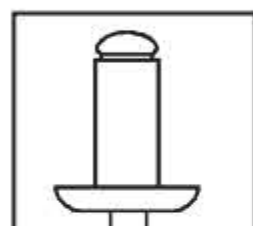

DOME HEAD

This is the most versatile type of head. It provides enough bearing surface to retain all kinds of materials, except those extremely smooth and brittle.

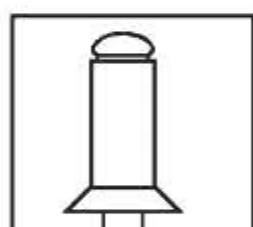

COUNTERSUNK HEAD

This type of head allows the riveting of a bigger thickness. It's designed to appear as a flat surface, flush with application.

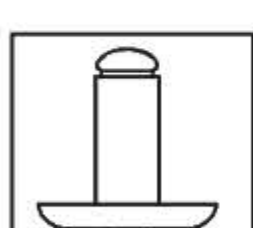

LARGE HEAD

This provides double the bearing area compared to the dome head and offers a great resistance. They are designed for applications where a soft or brittle material is assembled to a rigid support material.

EXTENSIVE RIVET RANGE

With over 4,500 products, BRALO lives up to its customers' high requirements to diversity of design and function, as well as in quality and cost.

HIGH QUALITY MATERIAL

At Bralo we test materials to ensure they meet the highest quality standards in our industry for safety, strength and durability.

PERSONALISED DESIGNS

We manufacture special designs in collaboration with our customers to meet their requirements and demands. Bralo is an innovative enterprise in constant growth offering customised fastening solutions and tailored services.

MATERIALS

Aluminium Mg (EN AW 6101)

Clear metal or coloured.

Applications in soft materials and with less resistance.

Aluminium Mg 2,5 (EN AW5052)

Clear metal or coloured. Applications where shear and tensile strengths are needed and with good resistance.

Aluminium Mg 3 (EN AW 5754)

Clear metal or coloured. Applications in soft materials.

It's used in Trebol rivet. High corrosion resistance

Aluminium Mg 3,5 (EN AW 5154)

Clear metal or coloured.

It's used for Standard rivets for all types of applications.

Aluminium Mg 5,0 (EN AW 5019)

Clear metal or coloured. It's used for Sealed rivets in applications

where shear and tensile strengths are needed. It has high resistance.

Steel

Common material.

Applications in resistant materials.

Stainless Steel (304, 316)

Corrosion resistance.

Applications where there are adverse weather conditions.

Copper

Thermal and electrical conductor.

Applications in soft materials.

Monel® (Nickel Copper Alloy)

High tensile strength.

High resistance to atmospheric corrosion, salt water, acids and alkaline solutions.

Technical data

With our fast installation, reduced operation cost and high productivity, there is always a solution at Bralo.

1. Put the rivet into the nosepiece and insert it into the hole.
2. Push the trigger of the tool so the mandrel enters into the rivet head. The hole is completely filled and the mandrel ejects.
3. The rivet is firmly applied. When finished the tool uses compressed air to expel the mandrel into the mandrel catcher.

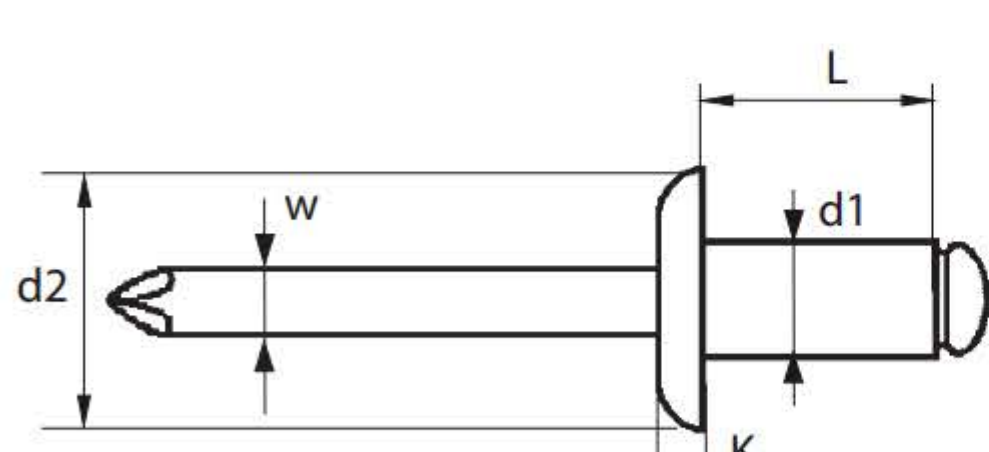
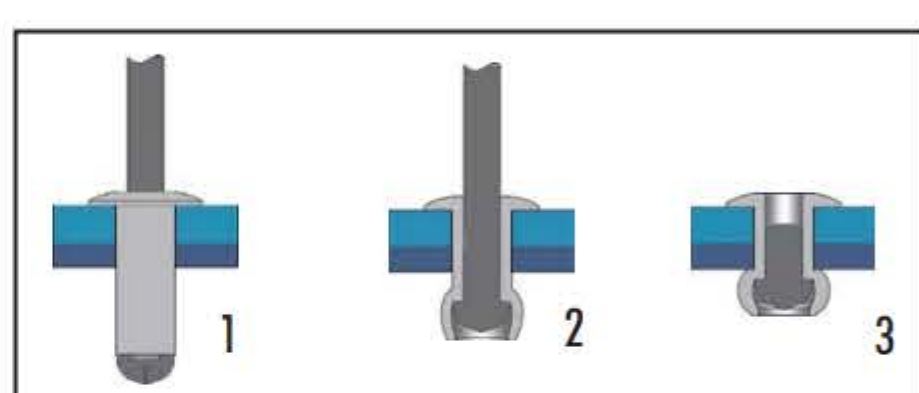

d1	Diameter of the body
d2	Diameter of the head
L	Length of the body
W	Diameter of the mandrel
K	Thickness of the head

Diameter of the hole (mm)

Grip range (mm)

STRENGTH

Shear strength (N)

Occurs when a riveted assembly is subjected to two opposed forces, applied in the same plane which is perpendicular to the symmetry axis of the rivet.

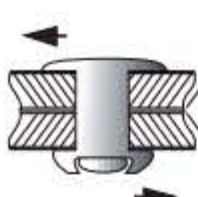

Tensile force (N)

Occurs when a riveted assembly is subjected to two forces in opposite directions applied in the symmetry axis of the rivet.

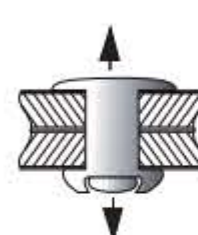

RIVETED STRENGTH PROCESS

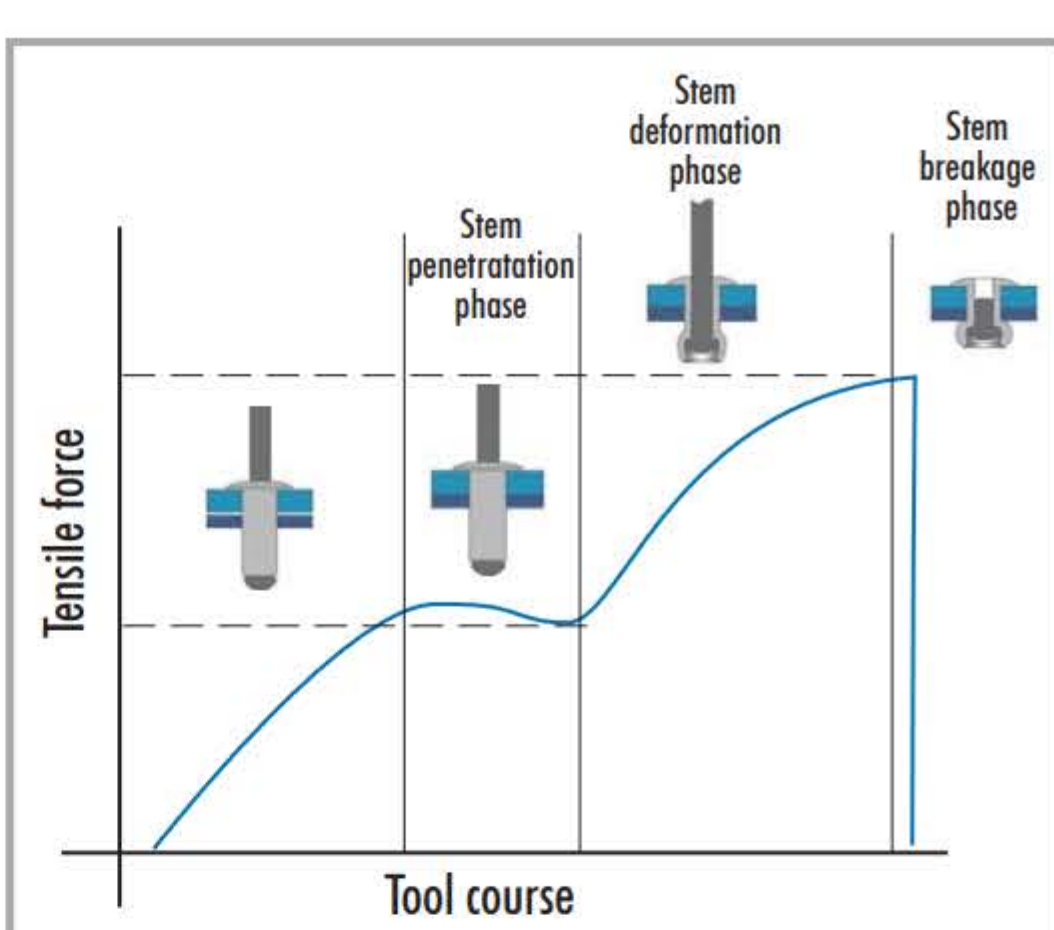

Lacquers and colours



Bralo have no limits when it comes to variety. Our extensive search for materials and our constant use of innovative technology have established the widest range of finishes in the market.

EPOXY PAINTING

Bralo standard rivets are available in an infinity of lacquering with liquid epoxy painting. From black to white, we have a range of over 100 RAL colours and we can make special lacquering upon request.

With working alongside the customer, we can make custom designs adapting to the specific needs of every application.



COLOUR/RAL

AVAILABLE COLOURS ACCORDING TO RAL CART

Colour	RAL	Code	Colour	RAL	Code	Colour	RAL	Code	Colour	RAL	Code	Colour	RAL	Code
Bronze	AB		Blue	5008	A8	Grey	7038	G0	Grey	7013	GS	Red	3027	R3
Brown	AM		Blue	5005	A9	Grey	9006	G1	Grey	7023	GU	Red	3003	R4
Black	AN		Blue	5014	AA	Grey	7022	G2	Grey	7043	GV	Red	3016	R5
Gold	AO		Blue	5022	AC	Grey	9002	G3	Grey	7042	GZ	Red	3002	RC
Silver	AP		Blue	5017	AD	Grey	7024	G4	Grey	7046	H6	Red	8012	RP
Copper	CU		Blue	5011	AE	Grey	7035	G5	Grey	7048	H8	Pink	3012	RO
Yellow	1021	J0	Blue	5020	AF	Grey	7037	G6	Grey	7048	HA	Orange	2004	NA
Yellow	1104	J1	Blue	5002	AG	Grey	9018	G7	Brown	8014	M0	Orange	2000	NB
Yellow	1028	J2	Blue	5008	AH	Grey	7032	G8	Brown	8019	M1	Orange	2001	NC
Yellow	1006	J3	Blue	5000	AJ	Grey	9007	G9	Brown	8024	M2	Green	6002	V0
Yellow	1003	J4	Blue	5018	AK	Grey	7016	GA	Brown	8004	M3	Green	6005	V1
Yellow	1004	J5	Beige	1014	B4	Grey	7000	GB	Brown	8017	M4	Green	6021	V2
Yellow	1018	J6	Beige	1011	B5	Grey	7031	GC	Brown	8023	M5	Green	6009	V3
Yellow	1023	J7	Beige	1015	BE	Grey	7040	GD	Brown	8028	M6	Green	6024	V4
Yellow	1017	JA	White	1013	B1	Grey	7030	GE	Brown	8025	M7	Green	6003	V5
Yellow	1034	JP	White	9001	B3	Grey	7011	GF	Brown	8007	M8	Green	6013	V6
Yellow	1032	JR	White		BL	Grey	7005	GG	Brown	8001	M9	Green	6008	V7
Blue	5010	AO	White	9016	BM	Grey	7015	GH	Brown	8022	MA	Green	6011	V8
Blue	5007	A1	White	9003	BS	Grey	7004	GI	Brown	8015	MC	Green	6019	V9
Blue	5001	A2	White	1010	BB	Grey	7021	GJ	Brown	8023	MN	Green	6020	VC
Blue	5012	A3	Cream	9001	C0	Grey	7047	GL	Black	9005	NO	Green	6018	VD
Blue	5021	A4	Cream	1002	C1	Grey	7033	GM	Black	9011	N1	Green	6028	VP
Blue	5009	A5	Burgundy	3005	D0	Grey	7003	GN	Red	3000	R0	Green	6022	V5
Blue	5003	A6	Burgundy	3007	D1	Grey	7009	GP	Red	3009	R1	Green	6027	VL
Blue	5013	A7	Red	3011	D2	Grey	7012	GR	Red	3020	R2	Green	6029	VM

The name of the colours is for guidance only.

