

# SEALED RIVET

Dome head

# STEEL/STEEL





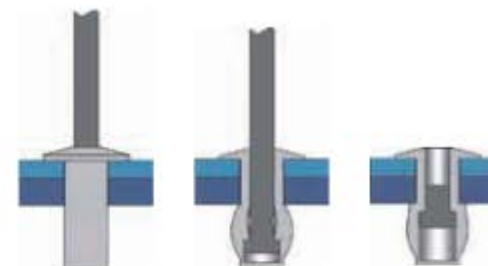
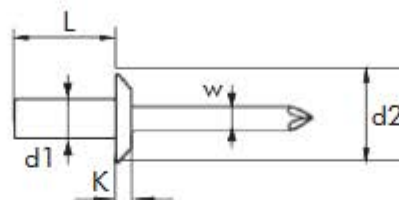

BODY: Steel Zincplated A3K

MANDREL: Steel Zincplated A3K

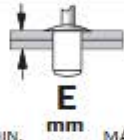

UNE - EN ISO 15976

d1 Ø mm	L Nominal mm	 mm	d2 Ø mm	K mm	W Ø mm	PACKAGING		 E mm MIN. MÁX.	 (N)	 (N)	REFERENCE
						 Inner	 Outer				
<b>3,2</b>	6,0	3,30	6,50	1,00	1,90	500	4.000	0,5 - 1,5	1150	1300	01290003206
	8,0					500	4.000	1,5 - 3,0			01290003208
	9,5					500	4.000	3,0 - 5,0			01290003209
	12,0					500	4.000	5,0 - 6,5			01290003212
<b>4,0</b>	8,0	4,10	8,20	1,40	2,30	500	4.000	1,5 - 3,0	1700	1550	01290004008
	10,0					500	4.000	3,0 - 5,0			01290004010
	12,0					500	3.000	5,0 - 6,5			01290004012
	15,0					500	3.000	6,5 - 10,5			01290004015
<b>4,8</b>	9,5	4,90	9,80	1,70	2,90	500	3.000	1,0 - 4,0	2400	2800	01290004809
	12,0					500	3.000	4,0 - 5,0			01290004812

Tests according to EN ISO 14589

