

GROOVED RIVET

Dome head





ALUMINIUM/STEEL

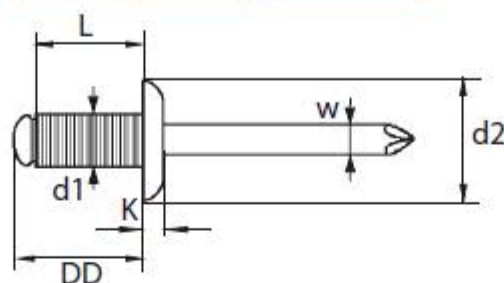

BODY: Aluminium Al Mg 3,5

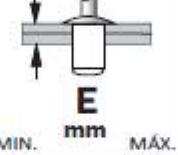
MANDREL: Steel Zincplated A1K



d1 Ø mm	L Nominal mm	 mm	d2 Ø mm	K mm	W Ø mm	PACKAGING		 E mm MIN. MÁX.	 (N)	 (N)	REFERENCE	DD (Drill Depth) mm
						 Inner	 Outer					
3,2	10	3,50	6,50	0,80	1,80	500	4.000	6,0	700	1100	01700003210	13
	4,0	8	4,30	8,00	1,00	2,20	500	4.000	4,0	900	1400	01700004008
						500	3.000	6,0			01700004012	15
						500	3.000	8,0			01700004016	19
4,8	8	5,10	9,50	1,10	2,73	500	3.000	4,0	1600	2600	01700004808	11
		10				250	2.000	6,0			01700004810	13
		12				250	2.000	8,0			01700004812	15
		14				250	2.000	10,0			01700004814	17
		18				250	1.500	13,0			01700004818	21
		21				250	1.500	15,0			01700004821	24
		24				200	1.200	20,0			01700004824	27

Tests according to EN ISO 14589

