

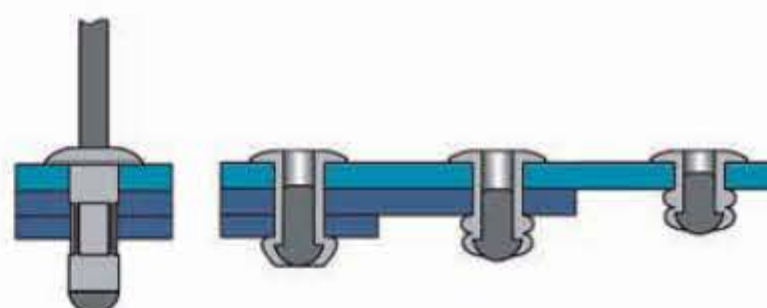

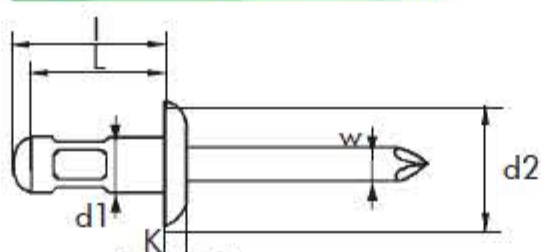

# MULTIGRIP RIVET

Dome head

# ALUMINIUM/STAINLESS STEEL

BODY: Aluminium Al-Mg 2,5  
MANDREL: Stainless Steel /Inox 304

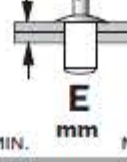
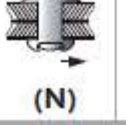

d1 Ø mm	L Nominal mm		d2 Ø mm	K mm	W Ø mm	PACKAGING		I Max. mm				REFERENCE	
						Inner	Outer						
3,2	8,0	3,30-3,50	6,20	1,10	1,80	500	4.000	10,50	0,5 - 5,0	650	1000	01089003208	
	11,0					500	4.000	13,00				4,0 - 8,0	01089003211
4,0	6,8	4,10-4,30	8,20	1,40	2,20	500	4.000	10,00	0,5 - 3,5	1050	1500	010890040068	
	9,5					500	3.000	12,00				1,0 - 6,0	01089004009
	12,5					500	3.000	15,00				4,0 - 9,0	01089004012
	16,5					500	3.000	19,00				6,0 - 13,0	01089004016
4,8	10,5	4,90-5,10	9,90	1,80	2,75	250	2.000	14,00	1,5 - 6,5	1500	2300	01089004810	
	15,0					250	2.000	18,00				4,5 - 11,0	01089004815
	16,5					250	1.500	20,00				6,5 - 12,5	01089004816
	24,5					200	1.200	28,00				12,5 - 20,0	01089004824

Tests according to EN ISO 14589



d1 Ø m/m	L Nominal m/m	PACKAGING		PAINTED COLOURS	
		Inner	Outer	REFERENCE	
3,2	8,0	500	4.000	01089	3208
	11,0	500	4.000	01089	3211
4,0	6,8	500	4.000	01089	40068
	9,5	500	3.000	01089	4009
	12,5	500	3.000	01089	4012
	16,5	500	3.000	01089	4016
4,8	10,5	250	2.000	01089	4810
	15,0	250	2.000	01089	4815
	16,5	250	1.500	01089	4816
	19,5	200	1.200	01089	4819
	24,5	200	1.200	01089	4824

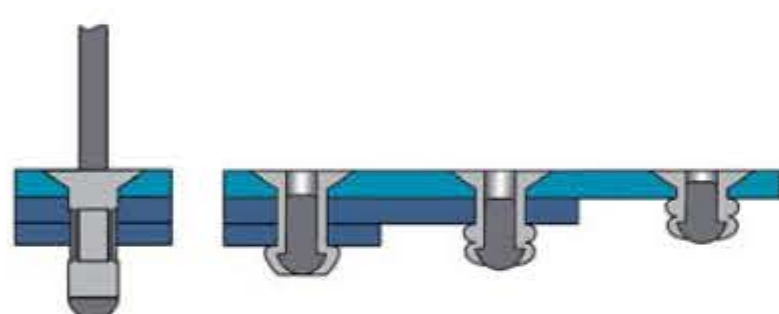

# ALUMINIUM/STAINLESS STEEL

# MULTIGRIP RIVET Countersunk head 120°

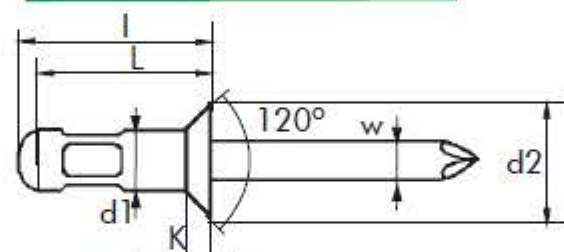

BODY: Aluminium Al Mg 2,5  
MANDREL: Stainless Steel /Inox 304

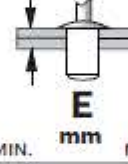
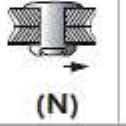

d1 Ø mm	L Nominal mm		d2 Ø mm	K mm	W Ø mm	PACKAGING		I Max. mm				REFERENCE
						Inner	Outer					
3,2	9,5	3,30-3,50	5,80	1,10	1,80	500	4.000	11,00	1,5 - 6,0	700	980	01099003209
4,0	11,0	4,10-4,30	7,30	1,30	2,20	500	3.000	12,80	2,0 - 8,0	1200	1600	01099004011
4,8	12,0	4,90-5,10	8,80	1,60	2,75	500	3.000	14,20	2,0 - 7,5	1500	2400	01099004812
	16,5					250	1.500	18,70				6,0 - 12,0

Tests according to EN ISO 14589

d1 Ø m/m	L Nominal m/m	PACKAGING		PAINTED COLOURS	
		Inner	Outer	REFERENCE	
3,2	9,5	500	4.000	01099	3209
4,0	11,0	500	3.000	01099	4011
4,8	12,0	250	2.000	01099	4812
	16,5	250	1.500	01099	4816

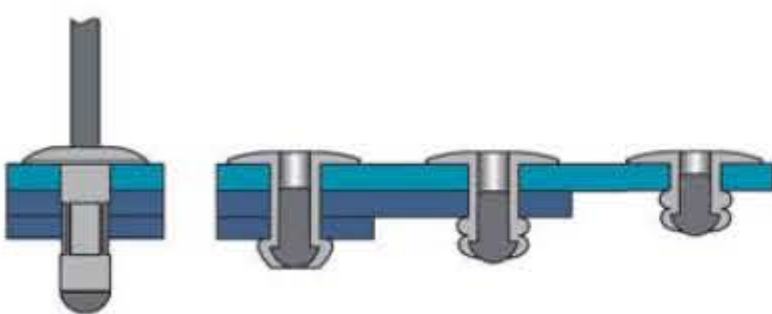

# ALUMINIUM/STAINLESS STEEL

# MULTIGRIP RIVET Large head

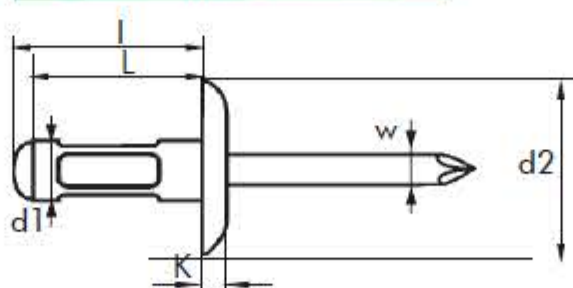

BODY: Aluminium Al Mg 2,5  
MANDREL: Stainless Steel /Inox 304

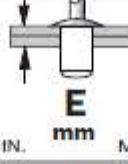

d1 Ø mm	L Nominal mm		d2 Ø mm	K mm	W Ø mm	PACKAGING		I Max. mm				REFERENCE	
						Inner	Outer						
4,0	13,0	4,10-4,30	12,0	1,60	2,20	250	1.200	15,50	3,0 - 9,0	1500	2400	01109004013	
4,8	10,5	4,90-5,10	16,0	1,80	2,75	200	1.200	14,00	1,5 - 6,0	1500	2400	01109004810	
	17,0					150	900	20,00				6,0 - 12,5	01109004817
	19,0					150	900	22,00				8,5 - 14,5	01109004819
	25,0					100	600	28,00				12,0 - 19,5	01109004825

Tests according to EN ISO 14589

d1 Ø m/m	L Nominal m/m	PACKAGING		PAINTED COLOURS	
		Inner	Outer	REFERENCE	
4,8	10,5	150	900	01109	4810
	17,0	150	900	01109	4817
	25,0	100	600	01109	4825

